

Call for Submissions:

The Tina Dolter Gallery at the Rotary Arts Centre 2026/2027

About The Rotary Arts Centre (RAC)

The RAC is a vibrant arts organization in Corner Brook, offering a 100-seat theatre, two galleries, five artist studios, and community spaces. We provide diverse programs in visual arts, theatre, dance, music, and film, supporting both emerging and professional artists.

About The Tina Dolter Gallery

The Tina Dolter Gallery at the Rotary Arts Centre is a dedicated exhibition space that showcases a dynamic range of work by both established and emerging artists. Exhibiting artists will have support during the exhibition process—including installation, marketing, and promotion—within a framework that values artistic excellence and professional development. This initiative fosters community engagement with contemporary art, while offering established artists a platform to share their work in a vibrant, creative environment and providing emerging artists with meaningful opportunities to build their practice.

The Tina Dolter Gallery is now accepting submissions for exhibition programming for the 2026/2027 season.

Submission Details

Submission Deadline: October 24th 2025

Notification of Acceptance: November 30th 2025

Exhibition Dates:

Slot 1: Late July - Late September 2026

Installation – 2 days

Deinstallation – 2 days

Slot 2: Late September - Mid November 2026

Installation – 2 days

Deinstallation – 2 days

Slot 3: Late November to Early January 2027

Installation – 2 days

Deinstallation – 2 days

(Please note that exact exhibition dates are subject to slight adjustments based on programming needs, and will be confirmed well in advance.)

Selection Process

Applications will be reviewed by a **jury of artistic peers**, made up of practicing artists and arts professionals with diverse backgrounds and disciplines. This jury process is designed to reflect a wide range of perspectives and lived experiences, and to support fair, thoughtful, and community-minded decision-making.

- **Artistic Merit:** Your artwork will be judged on its creativity, technical skill, originality, and overall impact.
- **Ability to Achieve Your Proposal:** Your submission should provide clear evidence that you have the capacity and plan to successfully complete your proposed artwork and any community engagement activities.
- **Local Relevance and Educational Value:** Your work will be evaluated on its connection to local culture or themes, and/or its potential to inspire, educate, or engage the Rotary Arts Centre community.

Who Can Apply

This call for submissions is open to **all visual art disciplines that can be displayed in a gallery**. This call is open to artists currently residing in Canada. At least one slot will be given to an artist in Atlantic Canada. Applicants may apply as individuals or as part of an artist collective.

While we welcome submissions from artists outside of Western Newfoundland, please note that all artists are responsible for their own costs related to shipping artwork and traveling to and from the gallery. We are able to provide support letters for travel or project funding applications for successful applicants.

We encourage submissions from artists of all backgrounds and experience levels. If you need help preparing your application, please don't hesitate to contact the Rotary Arts Centre staff, we're happy to assist. Your ideas and artistic voice are what matters most, and we understand that writing applications can be intimidating. Spelling or grammar mistakes will not be considered in the assessment of your application, and we will be accepting non written applications, such as video or audio applications.

Alternative submission formats will require you to include a short written summary of your proposal (max. 100 words), images, and links to audio/video work. If submitting a video or audio file, please ensure it runs no longer than 10 minutes.

Exhibition Terms and Artist Responsibilities

Submissions will be evaluated on creativity, originality, experimentation, and aesthetic impact. Selected exhibitions will run for approximately **50 days**, providing artists with the opportunity to **exhibit, sell, and promote their work**.

- The Rotary Arts Centre will retain a **30% commission** on all artwork sold.
- Artist(s) will receive CARFAC fees in alignment with CARFAC Fees 2026 (*Section 1 A1.1.1 Category I*)
- Artist(s) will be responsible for installation and deinstall of the works in the space, with assistance from staff. In the event that the artist(s) would not be able to be present during these processes, the artist will be responsible to organize and plan the installation process with the Visual Arts & Gallery Outreach Officer.
- Artist(s) is responsible for purchase of any wall paints that would be used in the gallery space and costs of repainting the gallery white at the end of exhibition.

Submission Requirements

Deadline: October 24th 2025

All submissions must be sent via email to **samantha@rotaryartscentre.ca** with the subject line: *Tina Dolter Gallery Submission*.

Required Documents

1. Cover Letter

- Include your current contact information (mailing address, email, and telephone number).
- Indicate your first and second choices for exhibition dates.
- If applying as a collective, list all member names and disciplines and designate a primary contact.

2. Project Description

- Outline the **media, technique, theme, and context** of the proposed exhibition.
- Indicate whether the exhibition is a completed body of work or still in progress (if it is in progress, please describe your workplan to complete the exhibition)
 - Address any specific **technical or spatial requirements** for installation.
- If your proposed project involves Indigenous peoples and/or Indigenous cultural knowledge, please describe your relationship to the people and cultural knowledge involved.

3. Artist Statement / Collective Statement

- Maximum **300 words**.
- Describe the artistic vision, creative philosophy, and intended impact on the audience.

4. Curriculum Vitae (CV) or Artistic Background Information

- Demonstrate an ongoing commitment to artistic practice.

5. Artwork Images

- Submit **10 individual .jpeg images** and/or up to 10 minutes of video or audio of your work. Images should be titled to include the information that corresponds with Image List

(i.e. SmithJosephine_Title_Year.jpg)

6. Corresponding Image list

Image list should provide:

- Title of artwork
- Size of artwork
- Medium
- Year produced
- If it will be part of the exhibition

We are open to accepting exhibition proposals in alternative formats including audio or video submissions. Alternative submission formats will require you to include a short written summary of your proposal (max. 100 words), images, and links to audio/video work. If submitting a video or audio file, please ensure it runs no longer than 10 minutes.

Gallery Specifications

The Tina Dolter Gallery is centrally located within the Rotary Arts Centre and is designed to accommodate a variety of exhibition formats. The gallery features seven white drywall sections backed by solid wood, ideal for hanging 2D artwork and capable of displaying 3D work within specified weight limits.

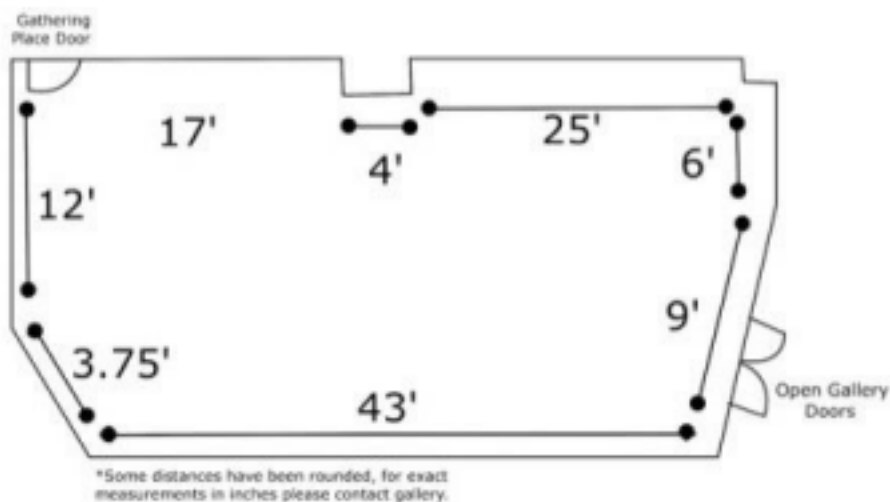

Diversity Statement

The RAC is committed to creating an inclusive and welcoming environment for all individuals. We encourage applicants from diverse backgrounds and life experiences to apply, recognizing that a wide range of perspectives enriches our work and strengthens our community. We value diversity in all forms and aim to ensure that all voices are heard and respected in both our organization and the broader arts community.

Submission & Contact Information

Email submissions to **samantha@rotaryartscentre.ca** by the deadline.

For any questions, please contact: **Sam Osmond, Visual Arts & Gallery Outreach Officer**

Email: **samantha@rotaryartscentre.ca**

We look forward to receiving your submissions!